

Required Tools

- 4mm Hex Key
- 10mm Open or Box End, or Crescent
- Torque Wrench (ft/lb or N·m)

Torque Specifications

All M6 fasteners should be tightened to 8.1 ft/lb (11 N·m).

Installation Plan

This plan should include the following steps:

1. The proper removal of the chair's back support canes in preparation for installation of Epic Seating.
2. The measurements of the user to establish the initial configuration of Epic Seating:
 - *The measurement of the distance from the top of the seat cushion to the users iliac crest. (used to determine height of pelvic support installation).*
 - *The initial angle of pelvic support installation. (Major, or macro, seat-to-back angle adjustment should be made using the chair's seat-to-back angle adjustment, following the OEM manual. Minor, or micro, depth or angle adjustment can then be made with the Epic pelvic support assembly.)*
 - *The location of the virtual pivot point that will line up with the user's greater trochanter. (Major, or macro, depth adjustment should be made using the chair's depth adjustment, following the OEM manual. Minor, or micro, adjustment can then be made with the Epic thoracic support assembly.)*

Before Installation:

Remove the back support, back support hardware, and back support canes from the chair.

Note that all fasteners should be installed inwards to the center of the chair (heads facing outward).

The tube nuts used in some model's adapter tubes may slip free during installation if both screws securing them are removed at the same time, and can be difficult to reposition. Make sure to retain their position with one of the screws at all times during installation.

Installation

Adapter Tube and Thoracic Support Assembly

Remove the three nylon lock nuts and washers from the button head screws on the adapter tubes. Remove the button head screws and washers from the adapter tube in sequence, placing them temporarily on the opposite side of the adapter tube to retain the position of the tube nuts inside the adapter tube.

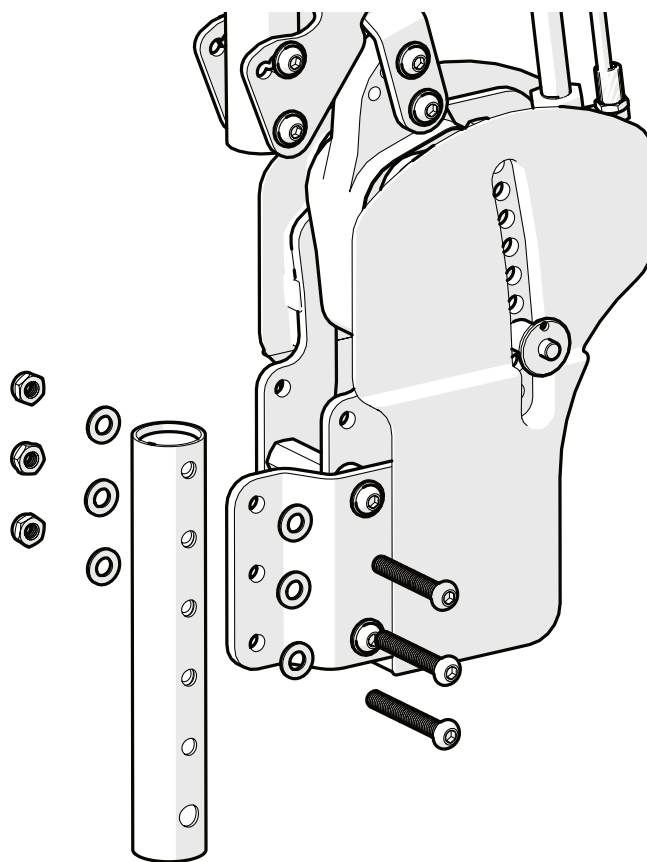

If one of the tube nuts should slide free and slip to the bottom of the adapter tube, simply release the tilt lock on that side, tilt the tube forward until the tube nut can slide back to its position. Relocate the threads with the fastener and secure the tube nut in position.

Line up the three holes in the mounting plate with the three holes in the adapter tube at the right height for the measurements in the installation plan, and secure the mounting plate to the adapter tube with the button head screws and washers. Torque the screws to the specifications listed earlier.

Pelvic Support Assembly

Loosen the screws securing the center plate on the pelvic support brackets. This will allow the width of the support to be adjusted to fit the width of the chair for installation.

Using the measurements taken of seat cushion to user's iliac crest, choose the proper location on the adapter tubes for the height of your pelvic support installation. Slide the slots of the mounting brackets over two of the three available screws per side of the pelvic support and secure with the M6 washers and nylon lock nuts removed in the first step. Torque these lock nuts to the specification noted earlier.

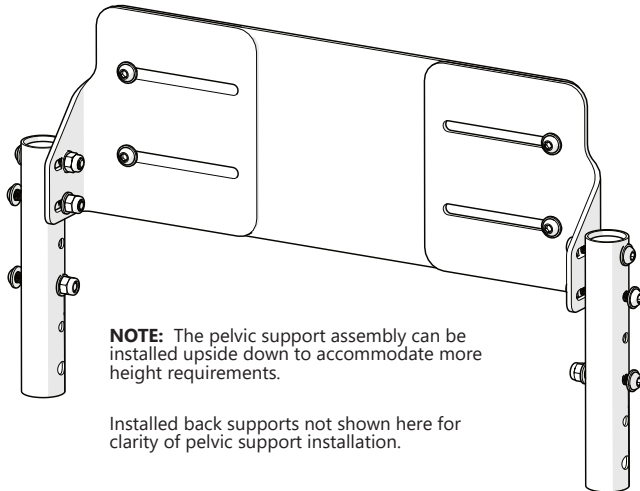

When the brackets are securely fastened to the adapter tubes, tighten the bolts securing the center plate to the torque specified.

Selecting Depth Setting

Depth configuration should be set to the setting that creates a line from the arc of movement to the top of the user's trochanter that is close to 9".

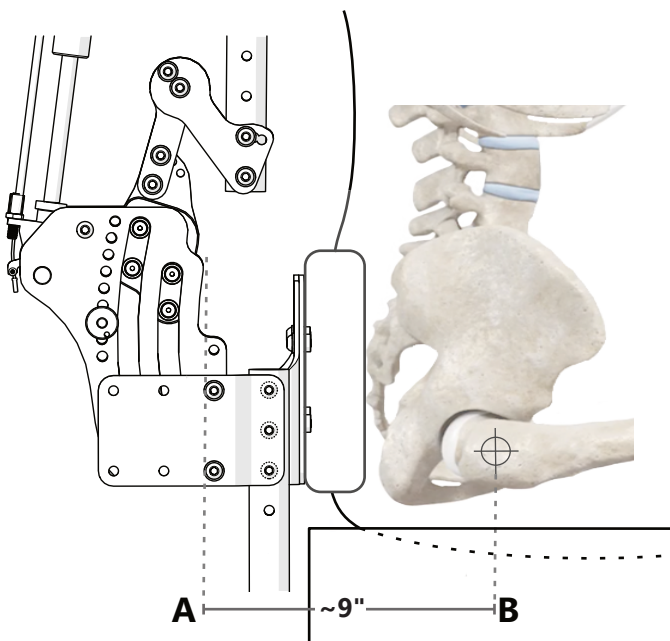

The following three options are possible:

The **FRONT** position represents the largest amount of seat depth, accommodating medium to large adult users.

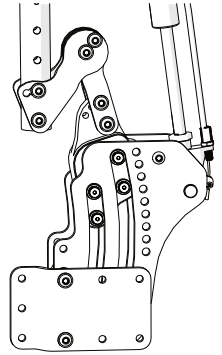

The **MID** position represents a medium amount of seat depth, accommodating a medium to small adult users.

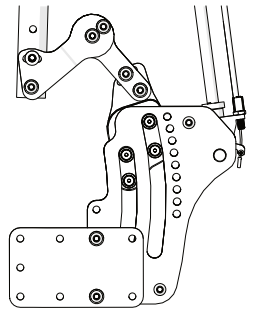

The **REAR** position represents the smallest amount of seat depth, accommodating small adult or child users.

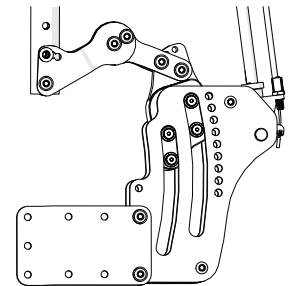

Notice in the images above, when the depth of installation is changed, the orientation of the back support canes must also be changed to retain correlation of back support to pelvic support.

More Information

To learn more about advanced installation topics or operation of the Epic Seating system, please visit the website at <https://stealthproducts.com/pages/epic-seating/>, or use the QR codes below.

Landing Page



User Manual

