

Epic Seating System Adapter Tube

Leggero ENZO (ESCTUN-004)

This adapter tube kit is intended to securely fit the Epic Seating System to a Leggero Enzo wheelchair.

Part	Description	Qty
A	Adapter Tube	1
B	Tube Nut	2
C	M6 x 1 x 45mm	3
D	M6 Washer	6
E	M6 Nylon Lock Nut	3
F	End Cap	1

Installation Instructions

1. Remove the caps covering the nuts on the pivot bolts.
2. With a hex wrench and socket, remove the pivot bolts from the backrest tubes. Retain the tube washers, and set the backrest tubes aside.
3. Using the same tube washers and pivot bolts, install the attachment tubes on the pivot assemblies and bolt into place using the pivot bolts and nuts removed in steps 1 and 2.
4. Tighten the pivot bolts and nuts to secure the attachment tubes in place, but do not overtighten. Using the release lever, check the pivot assemblies for free movement. Adjust as necessary. Replace the caps.*
5. Continue the installation as described in the installation section of the Epic Seating Owner's Manual.

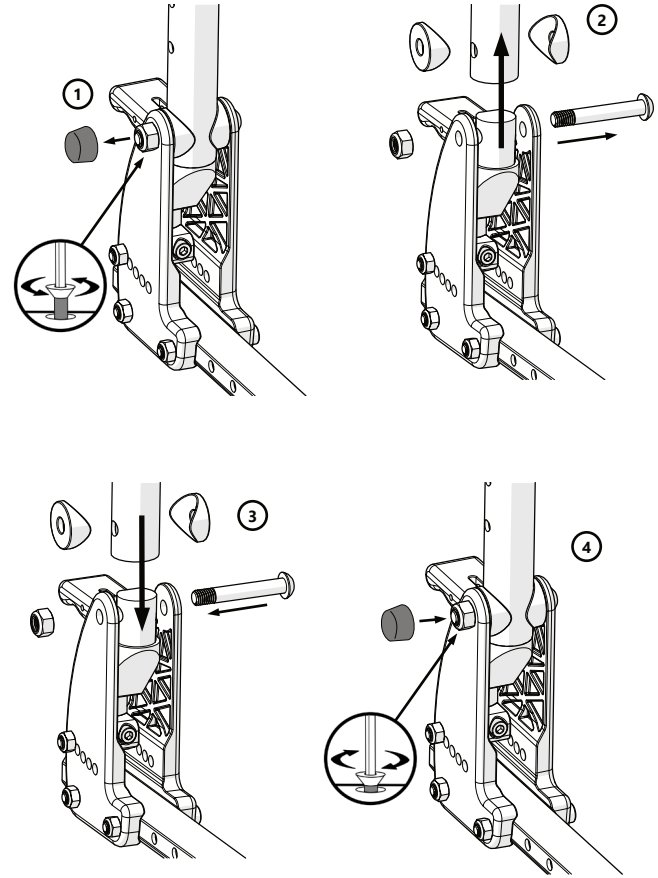

* For Leggero-specific information, please consult the manual that came with your Leggero chair.