

This adapter tube kit is designed to securely fit the Epic Seating System to a Freedom Designs Pro CG manual wheelchair.

| Part | Description | Qty | Torque |
|------|-----------------------|-----|--------|
| A | Adapter Plate | 2 | N/A |
| B | Adapter Rod | 2 | N/A |
| C | Locking Pin | 2 | N/A |
| D | M6 x 1 x 35MM BHS | 4 | 11 n-m |
| E | M6 x 1 Nylon Lock Nut | 4 | 11 n-m |

EPiC Seating System Adapter Set

Installation Guide

EPiC Seating System Adapter Tube Set Freedom Designs Pro CG

Customer Satisfaction

Stealth Products is committed to 100% customer satisfaction. Your complete satisfaction is important to us. Please contact us with feedback or suggestions to help us improve the quality and usability of our products.

You may reach us at:

Stealth Products, LLC

104 John Kelly Drive, Burnet, TX 78611



Phone: (512) 715-9995

Fax: (512) 715-9954

Toll Free: (800) 965-9229

Toll Free: (800) 806-1225

info@stealthproducts.com

www.stealthproducts.com

| | | |
|--|---|---|
| <div><div>EU</div><div>REP</div></div> <div></div> <div>PRIDE MOBILITY PRODUCTS EUROPE BV De Zwaan 3 1601 MS Enkhuizen The Netherlands</div> | <div><div>CH</div><div>REP</div></div> <div>SODIMED SA Chemin Praz Devant 12 1032 Romanel sur-Lausanne Switzerland</div> | <div>UK Authorized Representative</div> <div>PRIDE MOBILITY PRODUCTS LTD. 32 Wedgwood Road, Bicester, Oxfordshire OX26 4UL United Kingdom</div> <div></div> |
|--|---|---|

General

Read and understand all instructions prior to the use of the product. Failure to adhere to instructions and warnings in this document may result in property damage, injury, or death. Product misuse or failure to follow instructions will void the warranty.

Immediately discontinue use if any function is compromised, if parts are missing or loose, or if any component shows signs of excessive wear. Consult with your supplier for repair, adjustment, or replacement.

All persons responsible for fitting, adjustment, and daily use of the devices discussed in these instructions must be familiar with and understand all safety aspects of the devices mentioned. In order for our products to be used successfully, you must read and understand all instructions and warnings, and maintain our products according to our instructions on care and maintenance.

The installation instructions will guide you through this product's options and possibilities. Instructions are written with the expressed intent of use with standard configurations. They also contain important safety and maintenance information, as well as describe possible problems that can arise during use. For further assistance, or more advanced applications, please contact your supplier or **Stealth Products** at (512) 715-9995 or toll free at (800) 965-9229.

Always keep the operating instructions in a safe place so they may be referenced as necessary.

All information, pictures, illustrations, and specifications are based on the product information that was available at the time of printing. Pictures and illustrations shown in these instructions are representative examples and are not intended to be exact depictions of the various parts of the product.

Installation Instructions

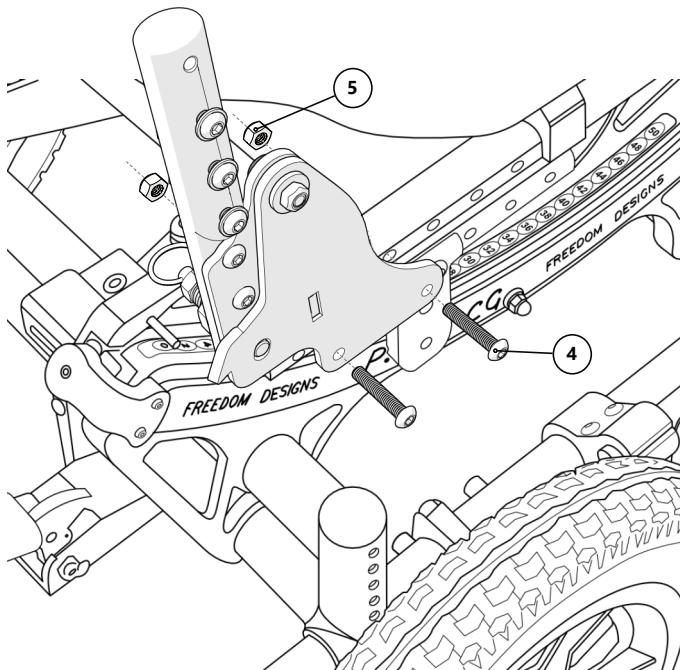

1. Remove any levers* for brake and tilt function from the canes and place them out of the way. Take care not to bend, crimp or pinch the cabling.
2. Remove the original back canes from the wheelchair base by removing the screws and lock nuts that secure them to the seat rail.
3. Select the mounting location along the seat rail that locates the adapter set in the best fore/aft position for the installation.

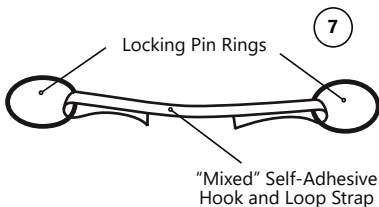

The hook and loop strap is intended to assist in the activation of both pins with one hand, leaving the other hand free to fold the system down, as needed. Leave enough slack in the strap to prevent unintentional release of the locking pins.

4. Select the mounting adapter that is proper for the side of the chair you are installing it on. The Locking Pin (C) ring should be located inside the canes and the other plate (when mounted). Insert the two M6 x 1 x 35MM BHS (D) through the Mounting Plate (A) and the seat rail at the location chosen in Step 3.
5. Use the M6 x 1 Nylon Lock Nuts to secure the Mounting Plate to the seat rail. Tighten the lock nuts to the torque specification shown on the table located on the front of this manual.
6. Repeat step 3 through step 5 for the other Mounting Plate (A).
7. Install the strip of mixed hook and loop between the rings of the Locking Pins, leaving a small amount of slack in the strip.
8. Continue with the installation of the EPiC Seating System as shown in the EPiC Seating System Manual.

* **NOTE:** Option of foot-operated tilt function on the frame is required to ensure compatibility with EPiC Seating.



© 2025, Stealth Products, LLC

Warranty Information



Home Page



Online User Manual



Stealth Products, LLC · info@stealthproducts.com · www.stealthproducts.com
(800) 965-9229 | (512) 715-9995 | 104 John Kelly Drive, Burnet, TX 78611