

This adapter tube kit is intended to securely fit the Epic Seating System to a Pride Fusion or Pride Sparky power wheelchair.

Part	Description	Qty	Torque
A	Adapter Tube	2	N/A
B	Mounting Plate	2	N/A
C	M8 x 1.25 Nylon-Insert Lock Nut	4	28 N·m

## EPiC Seating System Adapter Set

### Installation Guide

EPiC Seating System Adapter Tube Set  
for the **Pride Fusion or Pride Sparky** Wheelchair

## Customer Satisfaction

**Stealth Products** is committed to 100% customer satisfaction. Your complete satisfaction is important to us. Please contact us with feedback or suggestions to help us improve the quality and usability of our products.

You may reach us at:

## Stealth Products, LLC

104 John Kelly Drive, Burnet, TX 78611



Phone: (512) 715-9995

Fax: (512) 715-9954

Toll Free: (800) 965-9229

Toll Free: (800) 806-1225

[info@stealthproducts.com](mailto:info@stealthproducts.com)

[www.stealthproducts.com](http://www.stealthproducts.com)

<div><div>EU</div><div>REP</div></div> <div><div>C</div><div>E</div></div> <div><b>PRIDE MOBILITY PRODUCTS EUROPE BV</b> De Zwaan 3 1601 MS Enkhuizen The Netherlands</div>	<div><div>CH</div><div>REP</div></div> <div><b>SODIMED SA</b> Chemin Praz Devant 12 1032 Romanel sur-Lausanne Switzerland</div>	<div><b>UK</b> Authorized Representative</div> <div><b>PRIDE MOBILITY PRODUCTS LTD.</b> 32 Wedgwood Road, Bicester, Oxfordshire OX26 4UL United Kingdom</div> <div><b>UK CA</b></div>
---	---	---

## General

Read and understand all instructions prior to the use of the product. Failure to adhere to instructions and warnings in this document may result in property damage, injury, or death. Product misuse or failure to follow instructions will void the warranty.

Immediately discontinue use if any function is compromised, if parts are missing or loose, or if any component shows signs of excessive wear. Consult with your supplier for repair, adjustment, or replacement.

All persons responsible for fitting, adjustment, and daily use of the devices discussed in these instructions must be familiar with and understand all safety aspects of the devices mentioned. In order for our products to be used successfully, you must read and understand all instructions and warnings, and maintain our products according to our instructions on care and maintenance.

The installation instructions will guide you through this product's options and possibilities. Instructions are written with the expressed intent of use with standard configurations. They also contain important safety and maintenance information, as well as describe possible problems that can arise during use. For further assistance, or more advanced applications, please contact your supplier or **Stealth Products** at (512) 715-9995 or toll free at (800) 965-9229.

Always keep the operating instructions in a safe place so they may be referenced as necessary.

All information, pictures, illustrations, and specifications are based on the product information that was available at the time of printing. Pictures and illustrations shown in these instructions are representative examples and are not intended to be exact depictions of the various parts of the product.

# Installation Instructions

1. Carefully uninstall the lever for brake and tilt functions from the push handles and back support canes, if necessary. Position the cables such that they will not get pinched or kinked during the rest of the installation.

The hook and loop strap is intended to assist in the activation of both pins with one hand, leaving the other hand free to fold the system down, as needed.

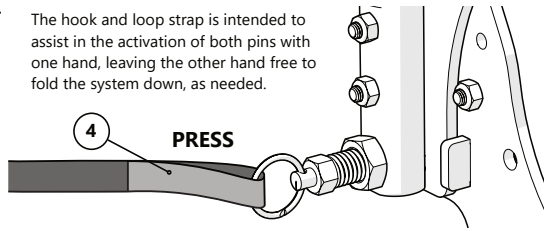

2. Remove the two fasteners securing the existing back support canes on both sides of the wheelchair. Set these fasteners aside.
3. Position the Mounting Plate (B) as shown in the illustration to the right. Use the two button head screws to attach each Mounting Plate (B) to the seat rail. Tighten these fasteners to the torque specification shown on the parts table.
4. Locate the 20" hook and loop strap and thread it through the rings attached to the locking pins on the bottom of the adapter tubes. Leave some slack in the strap and stick the hook and loop surfaces together as shown in the image on the upper right of the page.
5. Continue with the installation as described in the installation section of the Epic Seating Owner's Manual.
6. Once installation has been completed, route and secure the cabling and controls removed in Step 1. Install the control handles on the back canes of the Epic system, making sure to give each control enough room to operate correctly without impeding the function of any other control.

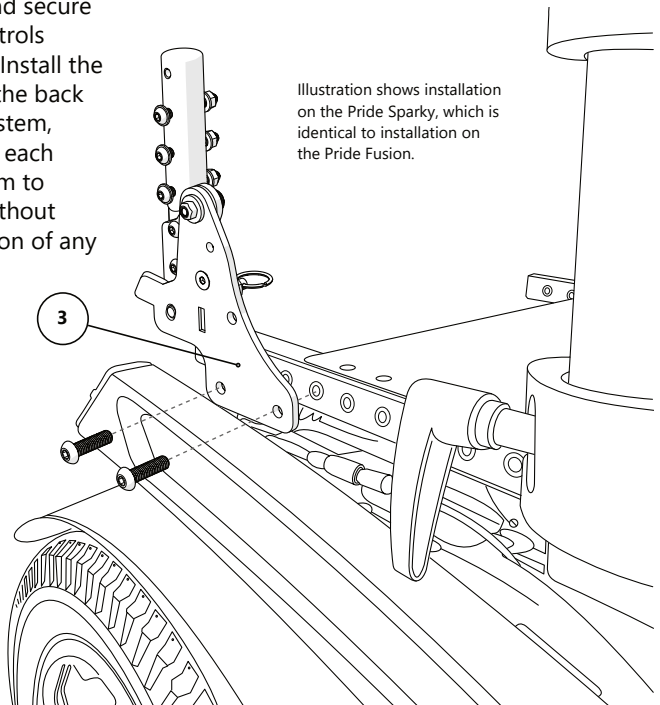

Illustration shows installation on the Pride Sparky, which is identical to installation on the Pride Fusion.



© 2025, Stealth Products, LLC

**Warranty Information**



**Home Page**



**Online User Manual**



Stealth Products, LLC · info@stealthproducts.com · www.stealthproducts.com  
(800) 965-9229 | (512) 715-9995 | 104 John Kelly Drive, Burnet, TX 78611